

Area Reserve," containing an area of 638 acres, more or less, RESERVING to the State of Hawaii, its successors and assigns, portions of Perpetual Non-Exclusive Access and Waterline Easement, Easement C (15.00 feet wide), more particularly described in Exhibit "A" and delineated on Exhibit "B," both of which are attached hereto and made parts hereof, said exhibits being respectively, a survey description and survey map prepared by the Survey Division, Department of Accounting and General Services, State of Hawaii, both being designated C.S.F. No. 25,234 and dated October 18, 2012.

SUBJECT, HOWEVER, to the condition that upon cancellation of this executive order or in the event of non-use or abandonment of the premises or any portion thereof for a continuous period of one (1) year, or for any reason whatsoever, the State of Hawaii, Department of Land and Natural Resources, Division of Forestry and Wildlife shall, within a reasonable time, restore the premises to a condition satisfactory and acceptable to the Department of Land and Natural Resources, State of Hawaii.

SUBJECT, FURTHER, to disapproval by the Legislature by two-thirds vote of either the Senate or the House of Representatives or by majority vote of both, in any regular or special session next following the date of this Executive Order.

This executive order does not authorize the recipient of the set aside to sell or exchange or otherwise relinquish the State of Hawaii's title to the subject public land.

IN WITNESS WHEREOF, I have hereunto set my hand and caused the Great Seal of the State of Hawaii to be affixed. Done at the Capitol at Honolulu this 31ST day of JULY, 2015.



DAVID Y. IGE
Governor of the State of Hawaii

APPROVED AS TO FORM:



JULIE H. CHINA
Deputy Attorney General

Dated: July 1, 2015



STATE OF HAWAII

Office of the Lieutenant Governor

THIS IS TO CERTIFY That the within is a true copy of Executive Order No. 4487 setting aside land for public purposes, the original of which is on file in this office.

IN TESTIMONY WHEREOF, the Lieutenant Governor of the State of Hawaii, has hereunto subscribed his name and caused the Great Seal of the State to be affixed.



SHAN S. TSUTSUI
Lieutenant Governor of the State of Hawaii

DONE in Honolulu, this 6th day of August, A.D. 2015





STATE OF HAWAI'I
SURVEY DIVISION
DEPARTMENT OF ACCOUNTING AND GENERAL SERVICES
HONOLULU

C.S.F. No. 25,234

October 18, 2012

ADDITION TO
KANAIO NATURAL AREA RESERVE

4487

Kanaio, Makawao, Maui, Hawaii

Being a portion of the Government Land of Kanaio including a portion of Lot 5 of Kanaio Homesteads.

Beginning at the southeast corner of this parcel of land, at the northeast corner of Parcel A of Kanaio Natural Area Reserve, Governor's Executive Order 3530 and on the boundary between the lands of Kanaio and Auwahi, the coordinates of said point of beginning referred to Government Survey Triangulation Station "PUU OLAI" being 2446.08 feet South and 36,087.01 feet East, thence running by azimuths measured clockwise from True South:-

1. 95° 59' 3938.32 feet along Parcel A of Kanaio Natural Area Reserve, Governor's Executive Order 3530;
2. 358° 51' 5652.60 feet along Parcel A of Kanaio Natural Area Reserve, Governor's Executive Order 3530 to the north side of Kanaio-Kalama Park Road;
3. Thence along the north side of Kanaio-Kalama Park Road, the direct azimuth and distance being:
107° 10' 35" 1623.71 feet;



TRUE NORTH

Scale: 1 in. = 1000ft.

Grant 1469, Ap. 3
to L.L. Torbert

Grant 4640 to J.H. Raymond

"PUU OULI"

638 ACRES,
MORE OR LESS

ADDITION TO KANAIO NATURAL AREA RESERVE

Kanaio, Makawao, Maui, Hawaii

Scale: 1 inch = 1000 feet

JOB No-245(10)
C. BK.

REDUCED NOT TO SCALE **EXHIBIT "B"**

SURVEY DIVISION
DEPARTMENT OF ACCOUNTING AND GENERAL SERVICES
STATE OF HAWAII

TAX MAP 2-1-03: Por. 50
C.S.F. NO. 25,234

62Y October 18, 2012
11" X 17" = 1.3 Sq. Ft.

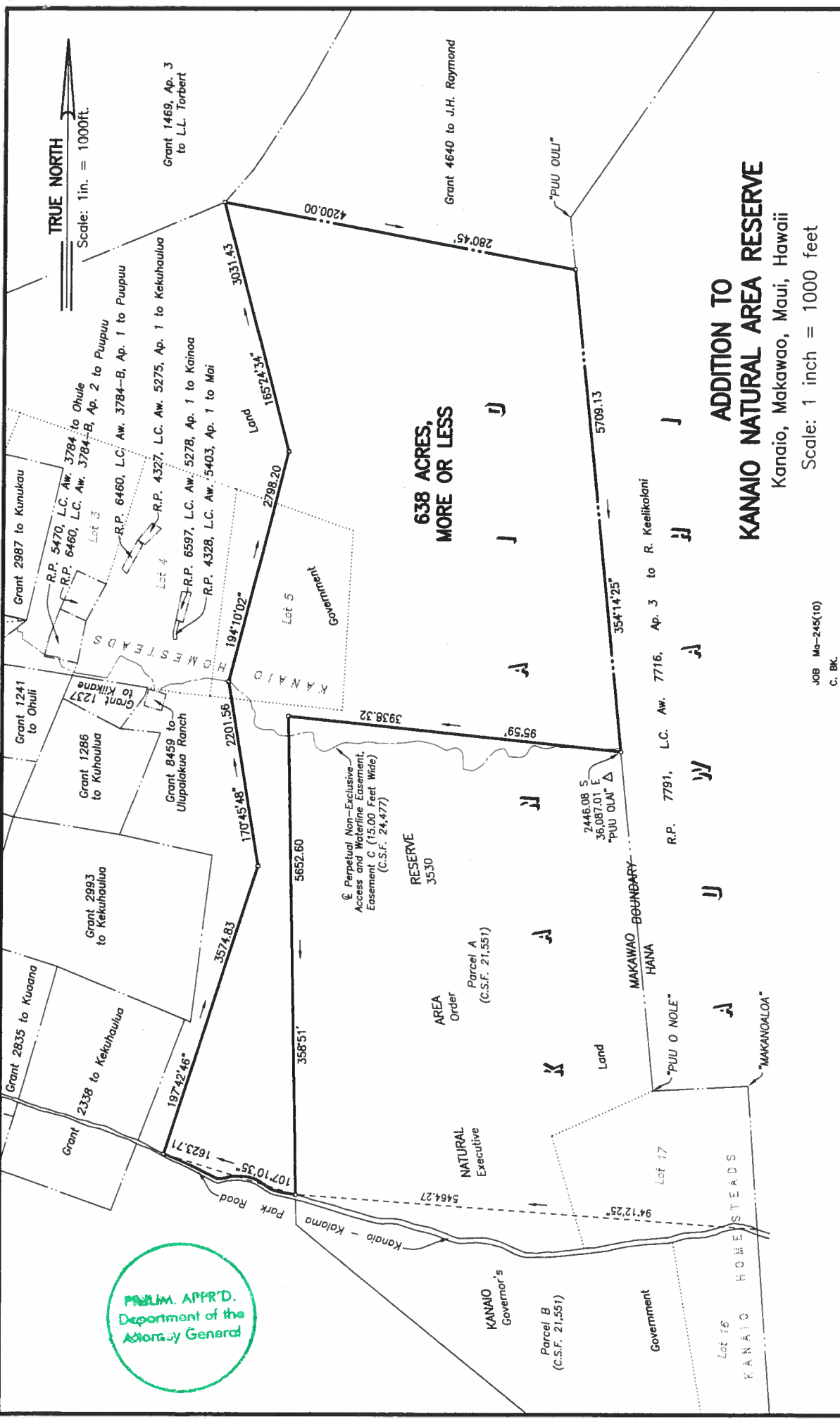

PRELIM. APPR'D.
Department of the
Attorney General